

CONDOMINIUM FOR SALE  
**FLORHAM PARK, NJ**  
256 COLUMBIA TURNPIKE

**COLUMBIA COMMONS - PROFESSIONAL OFFICE CONDO**

**AVAILABLE SPACE**

**Suite 207, 2nd Fl - North Tower:**

- Approx. 2700 sf, center unit with access from North & South Towers
- Professional office with loft and private bath
- 9-10 private offices, plus conference room
- Large - open workspace with high ceilings and natural light
- Reserved garage parking & storage room included

**BUILDING FEATURES**

- Well-maintained office complex
- Elevator
- Abundant on-site parking
- Conveniently located near hotels, restaurants, shopping, Lifetime Fitness
- Close to Routes 24, 287, 78 and GSP
- Mature landscaped grounds

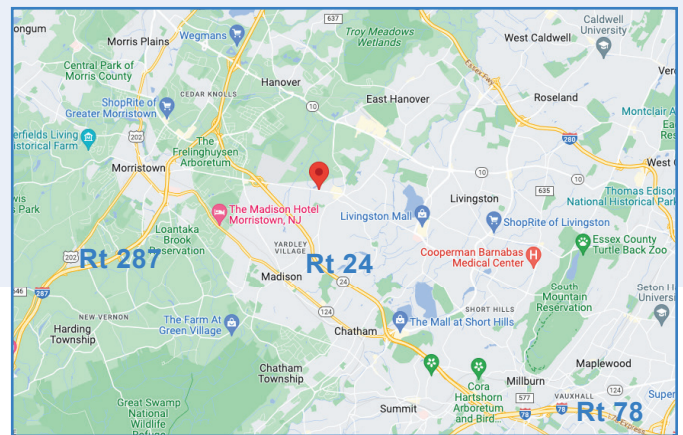

For more information contact:

**MARJORIE DORNE MURPHY**

C: 973.722.2979

O: 973.884.4444 ext. 14

[mmurphy@newmarkrealestate.com](mailto:mmurphy@newmarkrealestate.com)

**HELENE ELBAUM**

C: 201.320.3430

O: 973.884.4444 ext. 26

[helbaum@newmarkrealestate.com](mailto:helbaum@newmarkrealestate.com)

NewmarkRealEstate.com | 973.884.4444 | 7 E. Frederick Place Suite 500 Cedar Knolls New Jersey 07927

2024 Newmark Associates CRE. Information obtained from sources deemed to be reliable. However, no guarantee, warrant or representation is made as to accuracy of the information presented which is submitted subject to errors, omission, change of price, rental or other conditions, prior sale lease, financing or withdrawal without notice. Projections, opinions, assumptions or estimates are provided for example only, and may not represent current or future performance. Interested parties should consult their tax and legal advisors and conduct a thorough investigation of the property and any prospective transaction.

## Suite 207

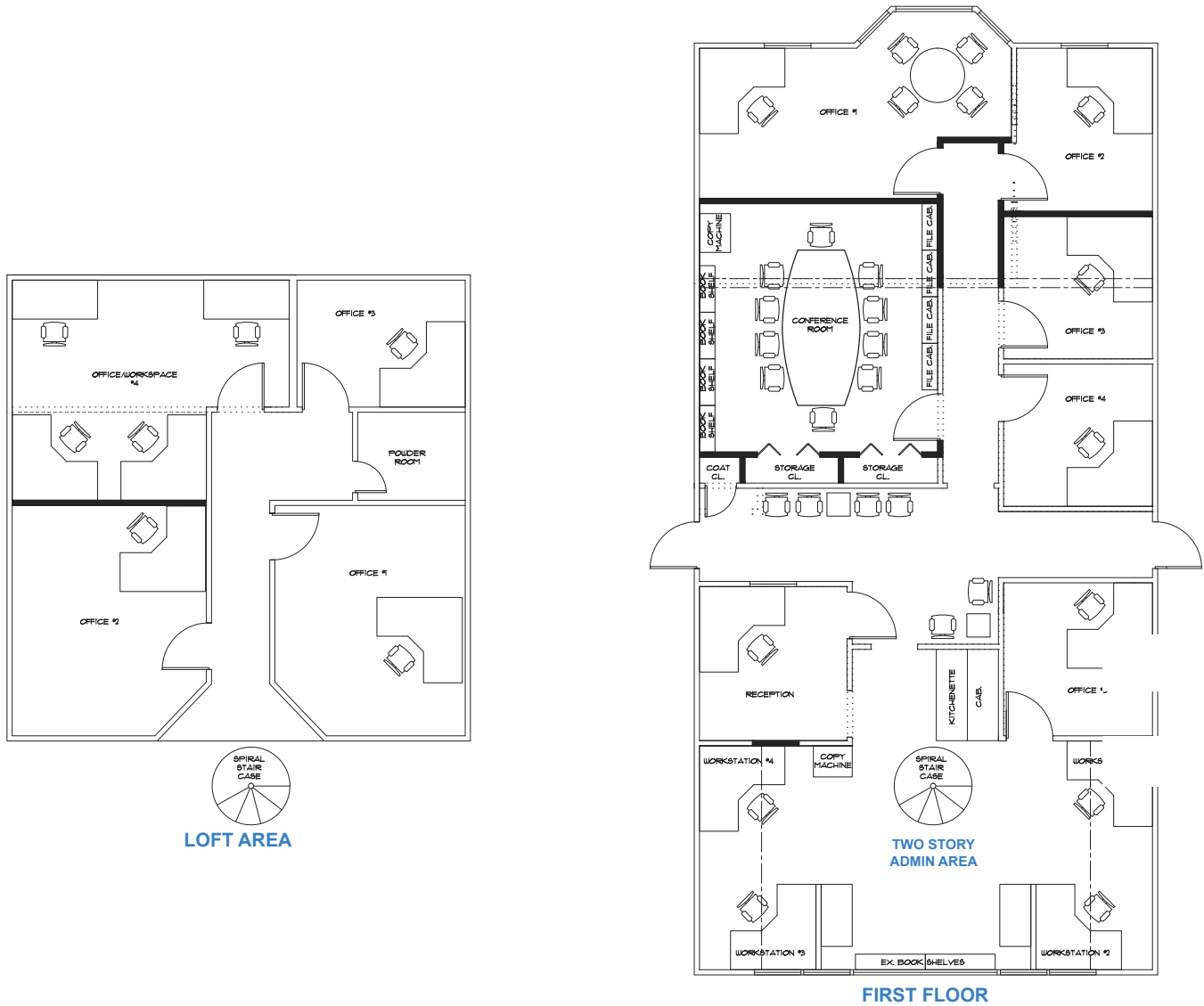

Floor plan not to scale