



FOR LEASE
DENVILLE, NJ
451 EAST MAIN STREET

AVAILABLE SPACE

- +/- 2600 - 4400 sf available (see table below)
- All units are newly renovated
- Freshly painted throughout
- New windows, doors, LED lighting
- Open warehouse with private restroom and utility sink
- Fully air conditioned & heated

BUILDING FEATURES

- 14' ceiling height
- Drive in loading (on specific units)
- New exterior façade
- On site parking
- Route 53/Main St. visibility

Rental Rate: \$14.50/psf NNN

Unit 453	+/- 4050 sf	1 Single Entry Door/1 Drive in Door LEASED
Unit 455	+/- 1500 sf	Double Glass Entry Doors LEASED
Unit 457	+/- 1140 sf	1 Single Entry Door LEASED
Unit 459	+/- 2600 sf	Double Glass Entry Doors
Unit 461	+/- 4400 sf	1 Single Entry Door/1 Drive in Door

For more information contact:

DEBORAH MYERS

C: 973.493.8508

O: 973.884.4444 ext. 15

dmyers@newmarkrealestate.com

NewmarkRealEstate.com | 973.884.4444 | 7 E. Frederick Place Suite 500 Cedar Knolls New Jersey 07927

2024 Newmark Associates CRE. Information obtained from sources deemed to be reliable. However, no guarantee, warrant or representation is made as to accuracy of the information presented which is submitted subject to errors, omission, change of price, rental or other conditions, prior sale lease, financing or withdrawal without notice. Projections, opinions, assumptions or estimates are provided for example only, and may not represent current or future performance. Interested parties should consult their tax and legal advisors and conduct a thorough investigation of the property and any prospective transaction.

FLOOR PLAN

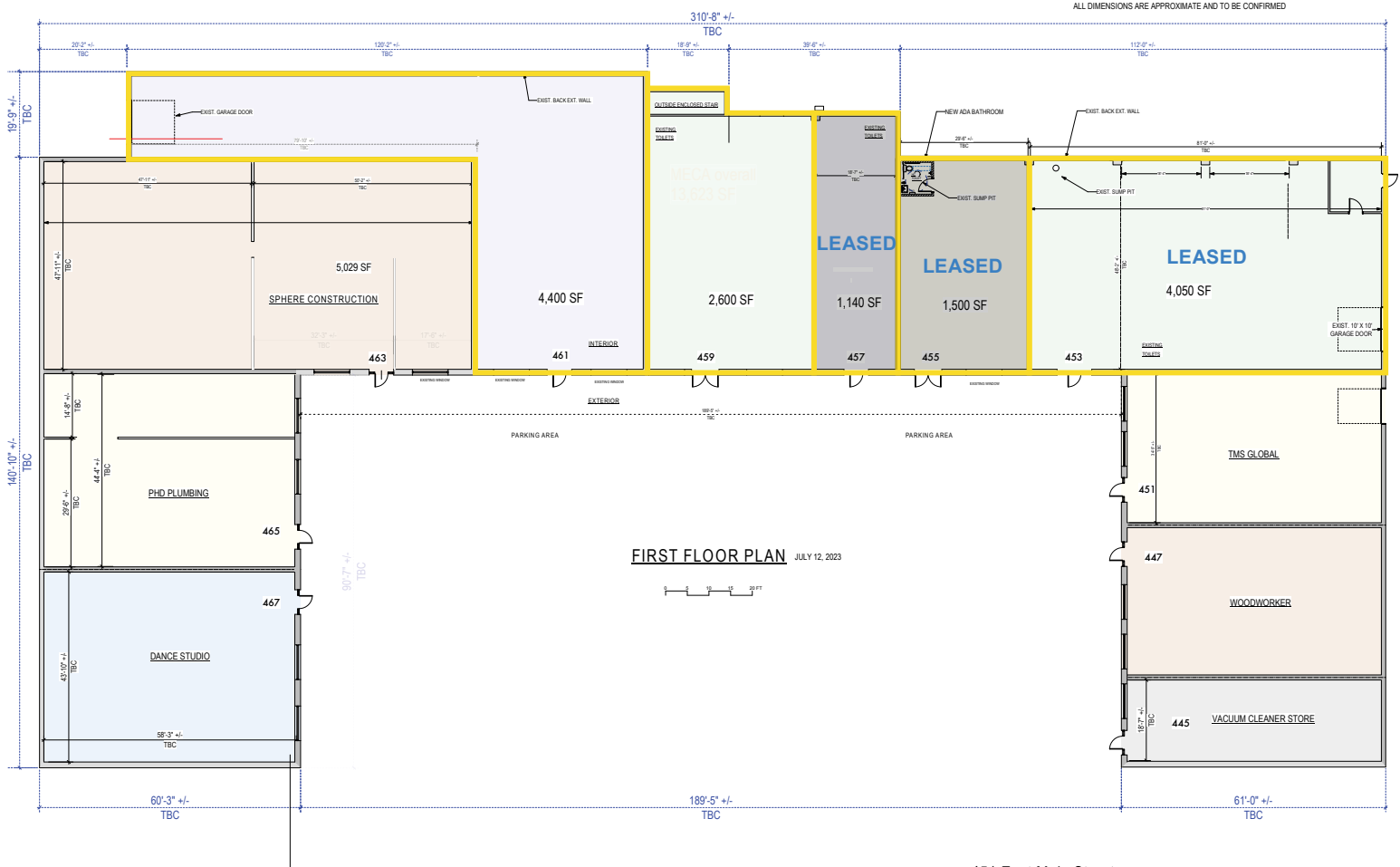

451 East Main Street
DENVER, NJ