



FOR SALE

FLORHAM PARK, NJ

29 COLUMBIA TURNPIKE, SUITE 302

## PROFESSIONAL OFFICE/MEDICAL CONDO FOR SALE

### PROPERTY FEATURES

- Approx. 2300 sf, 2nd Floor
- Divisible to +/- 1050 sf & +/- 1250 sf units
- Space available immediately
- Excellent condition
- Two large bullpen areas
- Two large executive offices
- Dry kitchen area
- Furniture available
- Two story building
- Prime location; excellent visibility!
- Common area bathrooms
- On-site open parking
- Close proximity to restaurants, banks, Livingston Mall
- Near Routes 24, 78, 280, GSP

**Asking Price: \$495,000**

**2024 RE Taxes: Approx. \$5,684**

#### For more information contact:

**HELENE ELBAUM**

C: 201.320.3430

O: 973.884.4444 ext. 26

helbaum@newmarkrealestate.com

**MARJORIE DORNE MURPHY**

C: 973.722.2979

O: 973.884.4444 ext. 14

mmurphy@newmarkrealestate.com





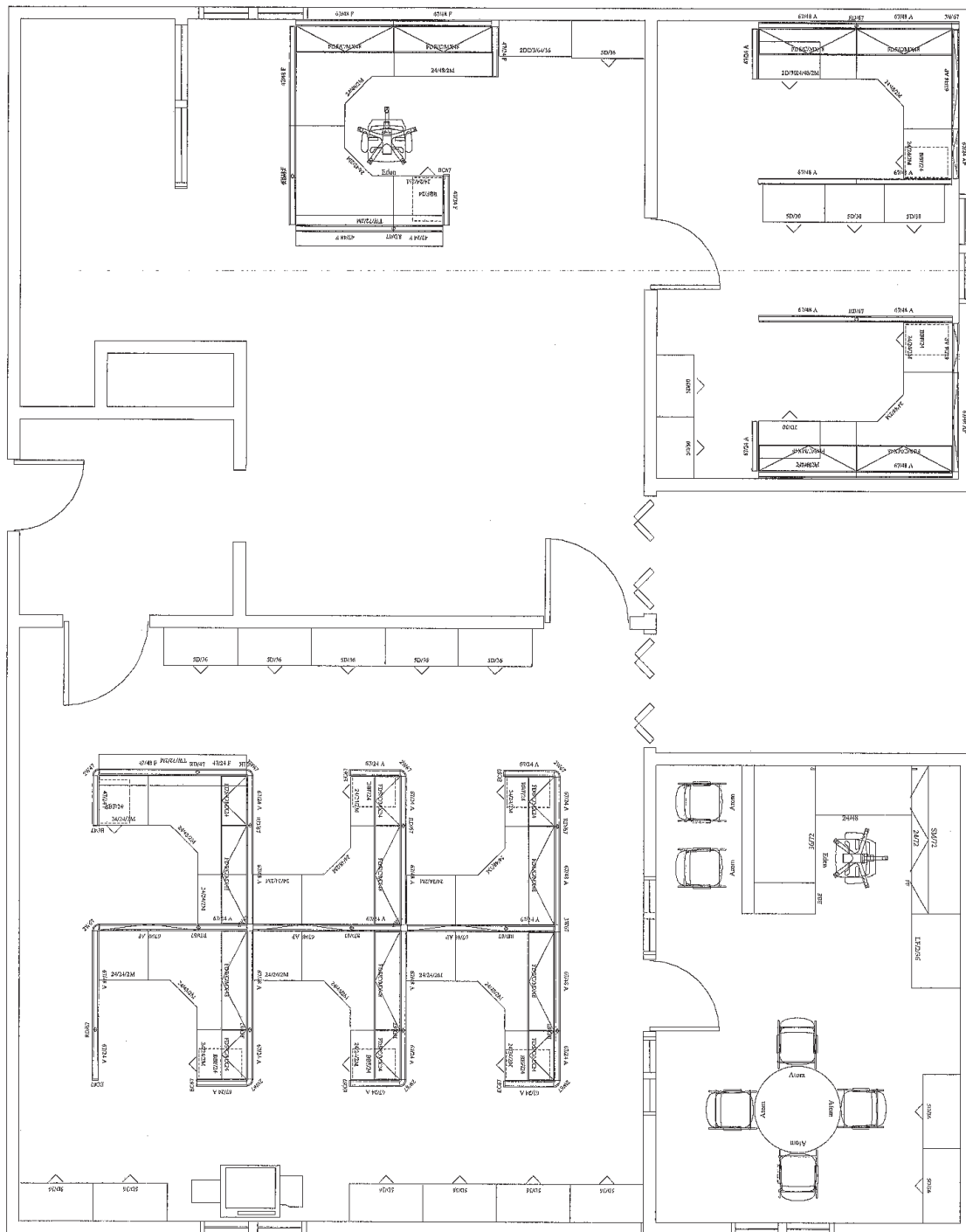

**Floor Plan Not Drawn to Scale.**